

MORE THAN VISIBILITY. REAL CONSUMER CONNECTION.



WILLOWBRIDGE SHOPPING CENTRE  
**RATE CARD**

WILLOWBRIDGE



## INDOOR ADVERTISING

Willowbridge Shopping Centre is a premium lifestyle destination designed for families and discerning shoppers seeking convenience, quality, and an elevated retail experience.

With a carefully curated tenant mix of 14 restaurants and coffee shops, lifestyle and entertainment offerings including a gym and Die Bron Theatre, and standout specialty retailers such as Noola, Yuppiechef, and The Biggest Little Beer Shop, the centre attracts an affluent, highly engaged audience.

Anchor tenants Woolworths, Pick n Pay, Dis-Chem, and @Home drive consistent daily foot traffic, while The Slow Market, hosting over 80 local traders every weekend, creates a vibrant atmosphere that encourages repeat visits.

Adding to this weekly rhythm is Wietse se Run, drawing over 500 runners every Saturday, further boosting morning foot traffic and brand exposure.

## TRADING HOURS

Monday - Friday	09:00 - 19:00
Saturday	09:00 - 18:00
Sunday	09:00 - 15:00
Public Holidays	09:00 - 17:00

## DEMOGRAPHICS

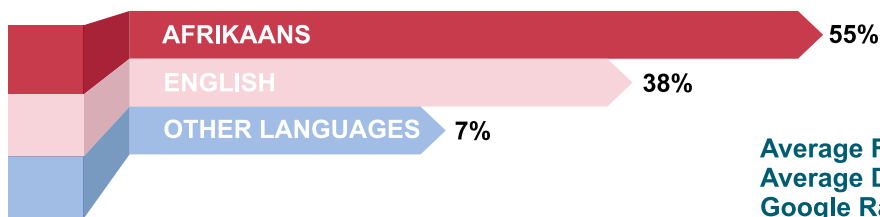
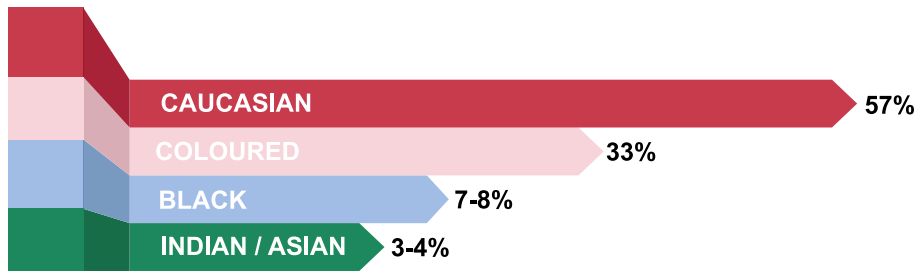
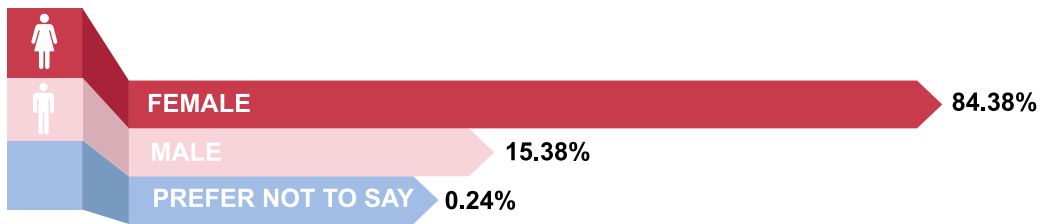

Average Foot Count : 350 000 Per Month  
Average Dwell Time : 64 Minutes  
Google Rating : 4.5

## FACILITIES & SERVICES

- Secure undercover parking
- Free Wi-Fi
- Electric vehicle charging stations
- Complimentary pensioner parking
- Admyt App (ticketless parking)
- VIP parking cards
- Slow Market (Saturday & Sunday)
- Five themed jungle gyms
- Greenbelt area
- Wheelchair-accessible facilities
- Baby changing facilities
- Animal-friendly centre
- Car wash facility
- Wietse Se Run (500+ runners every Saturday)
- Gas bottle vending machine
- Recycling vending machine
- Pudo & Bob Box Lockers
- Banks & ATM's
- Pensioner Parking Bays
- Moms & Tots Parking Bays
- Disabled parking and restroom facilities



WILLOWBRIDGE



# DIGITAL BILLBOARDS

Code : DB00  
 Slots Available : 6  
 Size : 2000 H x 4000 W  
 Artwork Size : 576 PX X 384 PX  
 Rental Per Slot : R 2675.00 Excl. VAT Per Month  
 Duration : 75 Minutes Per Client Per Day  
 : 300 x 15 Second Advertisements Per Client Per Day  
 Time : 10:00 – 22:00  
 Location : Above Dias Portuguese Restaurant & Old Khaki  
 : Facing Ou Meul Bakery & Col'Cacchio  
 : Close proximity to Woolworths & Yuppiefchef

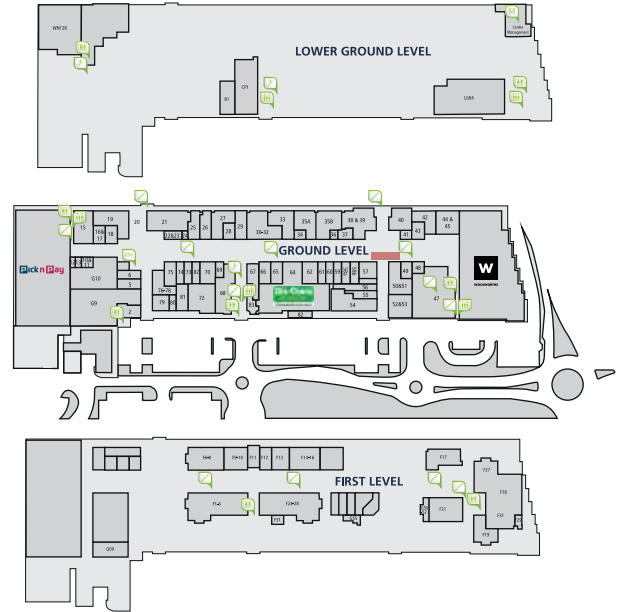

Code : DB01  
 Slots Available : 6  
 Size : 2000 H x 6000 W  
 Artwork Size : 960 PX X 320 PX  
 Rental Per Slot : R 2675.00 Excl. VAT Per Month  
 Duration : 75 Minutes Per Client Per Day  
 : 300 x 15 Second Advertisements Per Client Per Day  
 Time : 10:00 – 22:00  
 Location : Above Footgear  
 : Facing Carl Cronje Drive

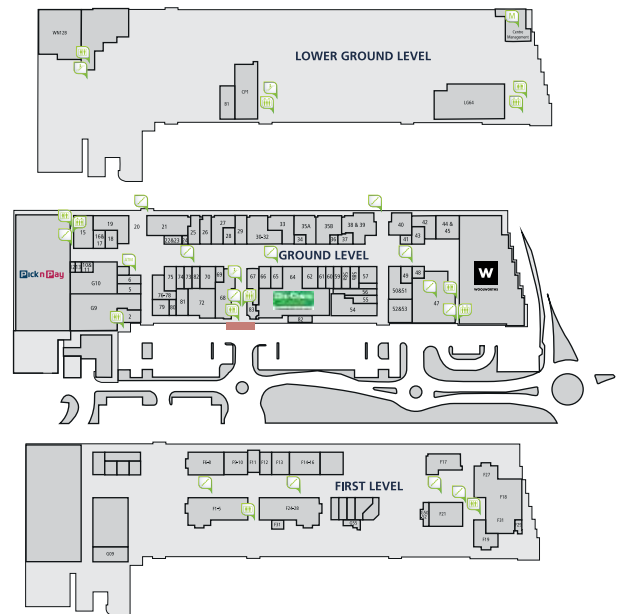

# INDOOR ADVERTISING

Code : WB01  
 Available : 8  
 Size : 2100 H X 1100 W  
 Rental Each : R 1380.00 Excl. VAT Per Month  
 Locations Available :

Woolworths	Ground Floor
Woolworths	P1
Die Bron	Upper Level
Footgear	Ground Floor
Footgear	P1
Regus (Offices)	Upper Level
PNP	Ground Floor
Zone Fitness	P1

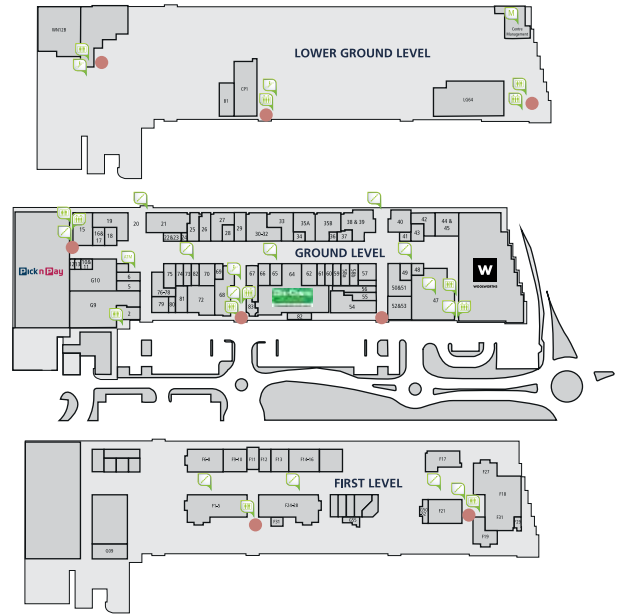

Code : WB02  
 Available : 10  
 Size : 600 H x 900 W  
 Rental Each : R 1284.00 Excl. VAT Per Month  
 Locations Available :

Checkers Outdoor Entrance	2 x Entry Booms
Central Entrance	2 x Entry Booms
Woolworths Entrance	2 x Exit Booms
	2 x Entry Booms
	2 x Exit Booms

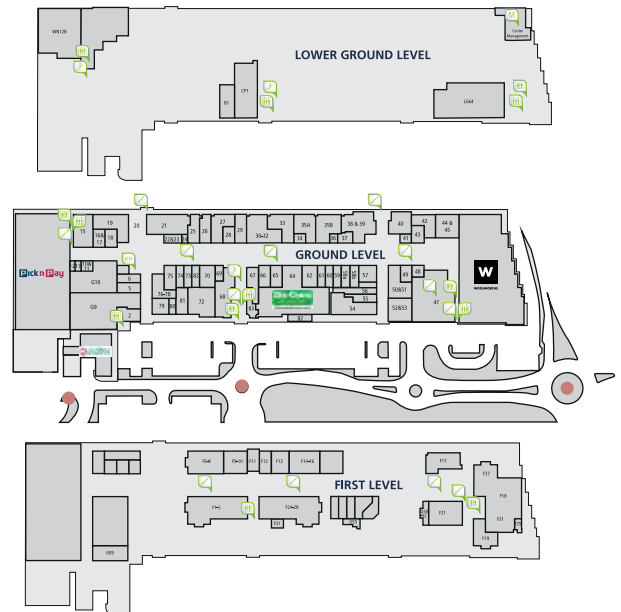

# INDOOR ADVERTISING

Code : WB03 Available : 4  
 Size : 800 H X 1100 W  
 Rental Each : R 3600.00 Excl. VAT Per Month

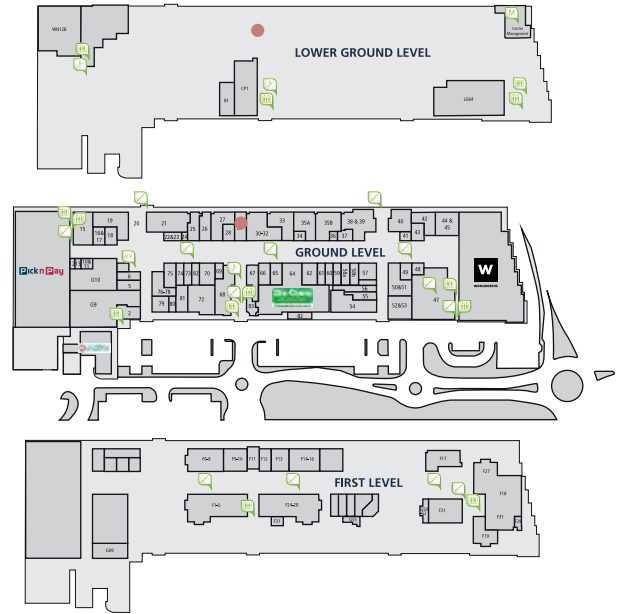

Code : WB04 Available : 50  
 Size : 920 H x 1950 W  
 Rental Each : R 520.00 Excl. VAT Per Month

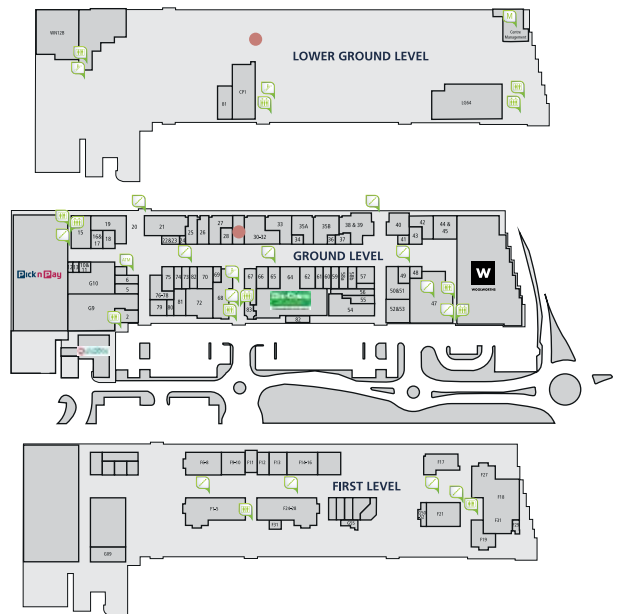

# INDOOR ADVERTISING

Code : WB05 (Lightbox)  
 Available : 1  
 Size : 1595 H X 1995 W  
 Rental Each : R 2675.00 Excl. VAT Per Month  
 Location : P1 Woolworths Foyer



Code : WB06 (Lightbox)  
 Available : 1  
 Size : 1400 H x 1690 W  
 Rental Each : R 2675.00 Excl. VAT Per Month  
 Location : Woolworths Stairs



# INDOOR ADVERTISING

Code : WB08  
 Available : 1  
 Size : 3600 H x 2370 W  
 Rental Each : R 2675.00 Excl. VAT Per Month  
 Location : Woolworths Foyer Entrance



Code : WB09 (Lightbox)  
 Available : 1  
 Size : 1550 H x 1800 W  
 Rental Each : R 2500.00 Excl. VAT Per Month  
 Location : PNP Stairs



# EXHIBITION COURTS

Exhibit your brand at Willowbridge Shopping Centre, a distinctive lifestyle destination designed for high-impact activations and immersive brand experiences.

With an affluent, engaged audience and strong daily foot traffic, Willowbridge offers the ideal environment to connect meaningfully with shoppers.

Our spacious exhibition courts are perfectly suited for vehicle displays, product launches, and experiential activations, providing excellent visibility within a refined, family-friendly setting. Position your brand where lifestyle, leisure, and purchasing power meet.

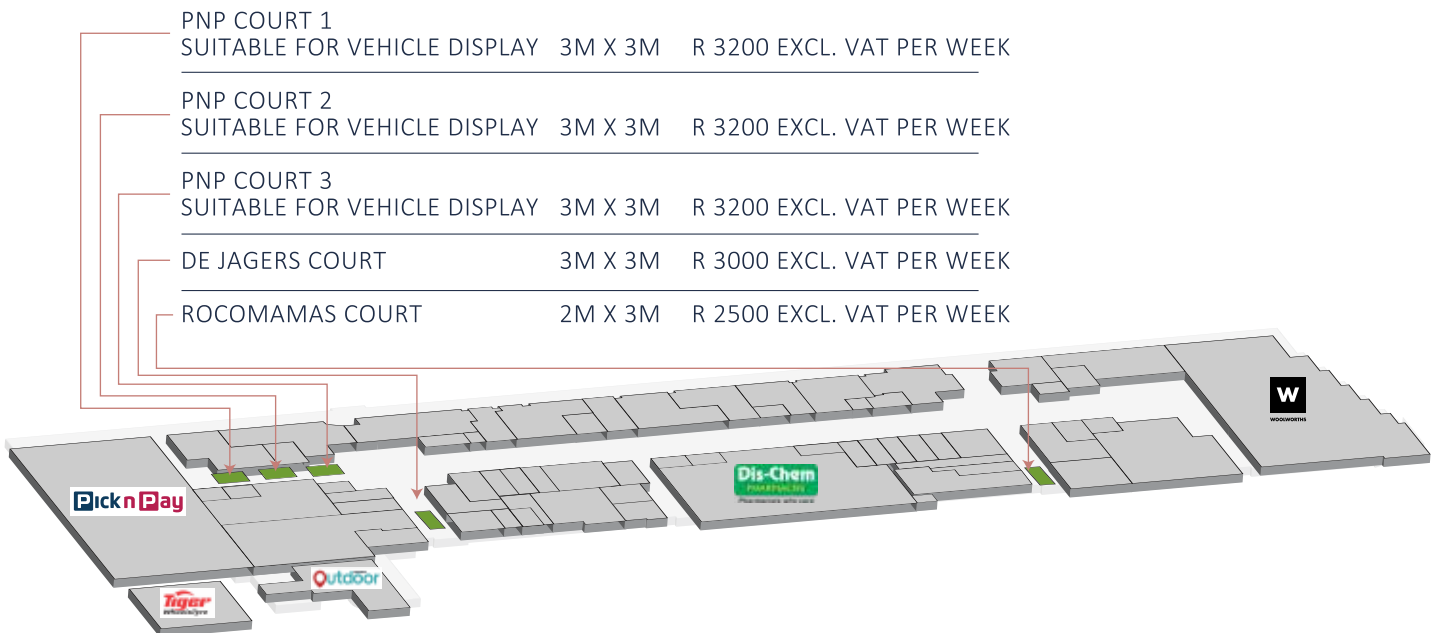

# FOR BOOKINGS

Email : [Lizelle@willowbridgecentre.co.za](mailto:Lizelle@willowbridgecentre.co.za)

Please note : Bookings run Tuesday to Monday; daily rates not available.  
Flooring and design/production costs for advertising are excluded.  
Adhere to Shopping Centre trading hours.  
Flyers/promotions only allowed within your allocated court.  
Stands must be set up before 09:00 and manned during trading hours.  
Parking included.  
No eating/drinking at stands.  
Professional, pre-printed signage only; no handwritten signs.  
Amplified sound or music requires pre-approval.  
Follow health, safety, and fire regulations.  
No aggressive selling, obstruction, or disruption.

